



Planners' Lab 2023

Learning/Living
correlation of learning
and urban infrastructures



About the PlannersLab 2023 | Concept

Support for the learning processes in the city is just as important as any other measure. The concept of the learning city highlights the necessity to expand and diversify the spaces for all types of learning and all types of learners, as well as accommodate the knowledge in and on the city. The learning infrastructure, however, does not exist in vacuum — it is interconnected and correlates with other urban infrastructures and systems. For example, a student city needs a sufficient housing infrastructure for the learning infrastructure to be able to sustain the students. Or does it?

This codependency of learning with other infrastructures brings us to fundamental questions of urban planning and well-balanced urban development, which we will investigate at the PlannersLab 2023. We are inviting young scholars and researchers to become the students of Viadrinum 2023 and to merge in this process, having an opportunity to learn from two cities at once: Frankfurt (Oder) and Słubice.

Maintaining the focus on the integration of the learning processes in Frankfurt (Oder), including the student student life of Viadrina University, with the other systems of the city, the students are invited to learn in-depth and conduct functional and stakeholder analysis, to study the city's housing sector and to use ASB (analysis, synthesis, evaluation) methodology to develop a vision for the Zukunftsplatz in the city — a possible urban focal point for integration of the learning city concept in Frankfurt (Oder).

About the PlannersLab 2023 | Participants



**We are a group of 13 people from 10 countries
with a diverse background of disciplines!**

Curators: Toralph Weise, Yuliia Popova

Summer School 2022 – to Summer School 2023



2022



2023

Summer School 2022 – to Summer School 2023

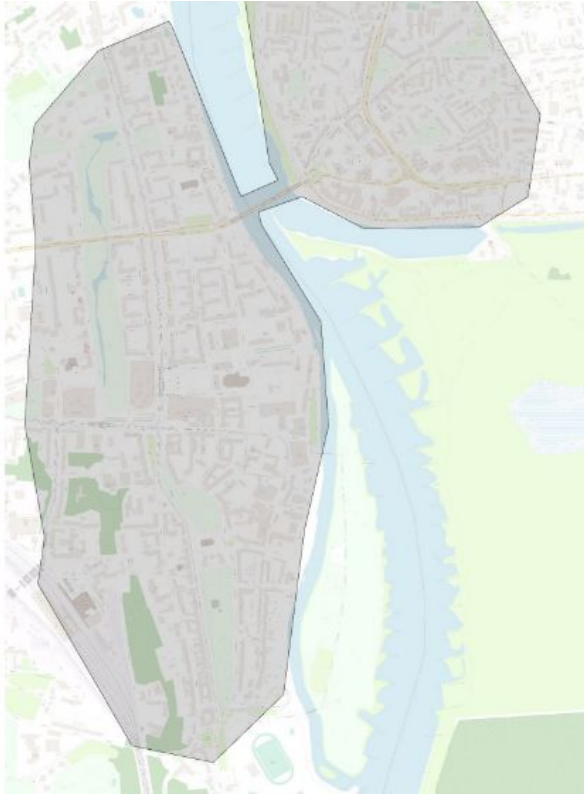

Layers of analysis of the team 2022. We picked up where they finished.

Summer School 2022 – to Summer School 2023



In 2022, it was not yet decided if Zukunftszentrum (Future center) was yet to happen. In 2023, it was clear that the project will not take place and Zukunftsplatz with its surroundings remain open for interpretations.

Summer School 2022 – to Summer School 2023

Threats: If “Center for the Future” will be build. Scenario 1

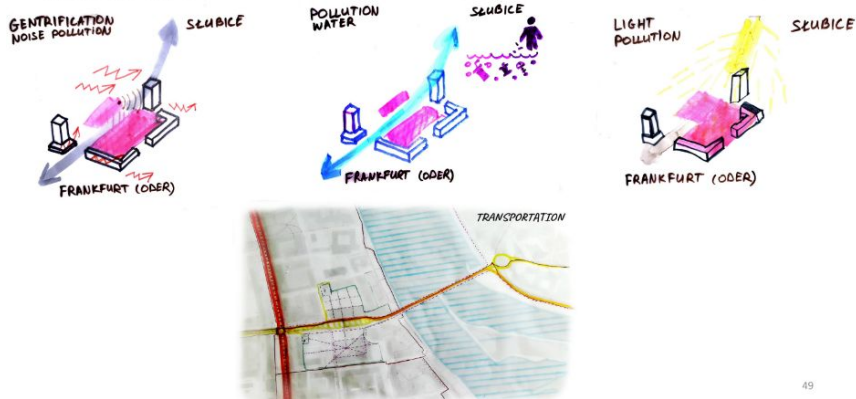

Threats: If investments will not come. Scenario 2

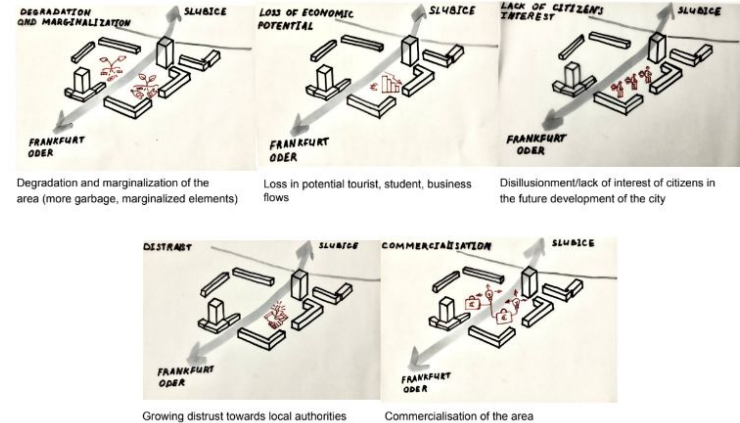

Planner'sLab 2022 worked out scenarios for both outcomes with the Center.
We found ourselves with the Scenario 2 in 2023.

Summer School 2022 – to Summer School 2023

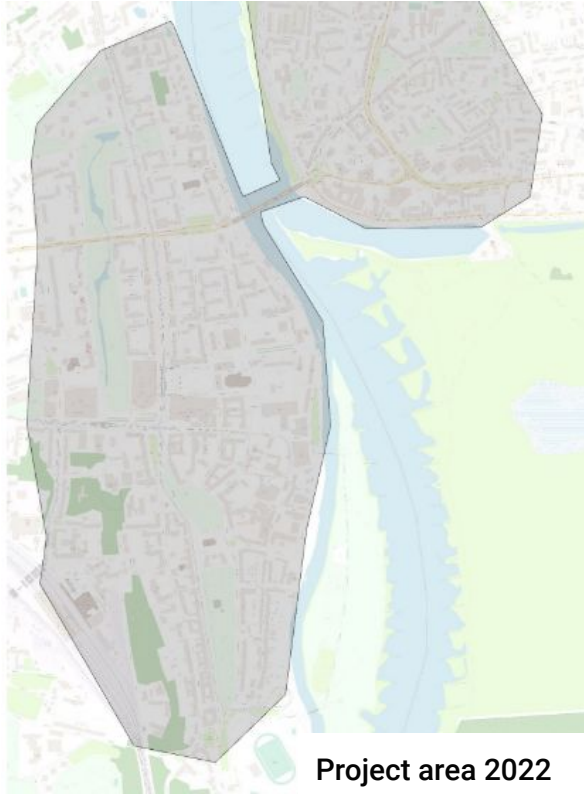

Project area 2022

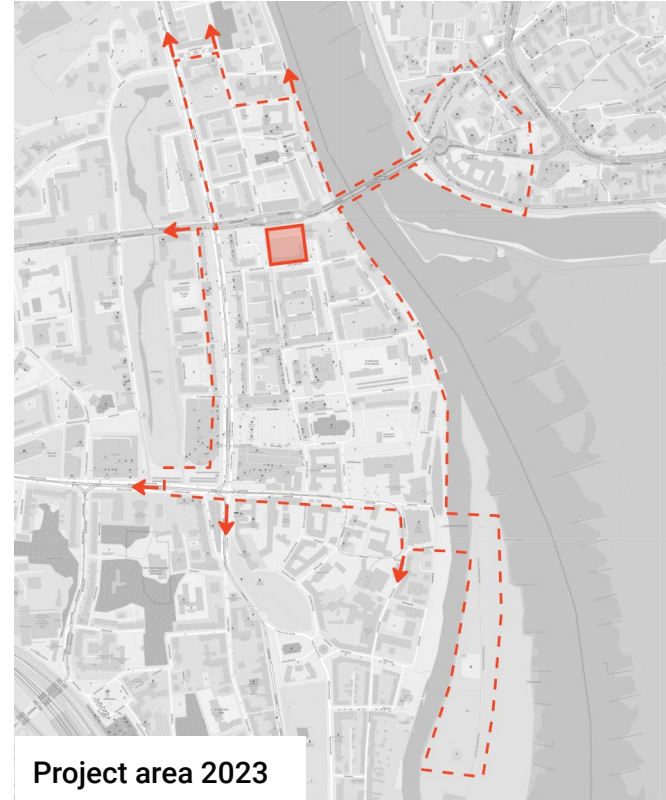

Project area 2023

Analysis



Synthesis



Evaluation

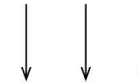
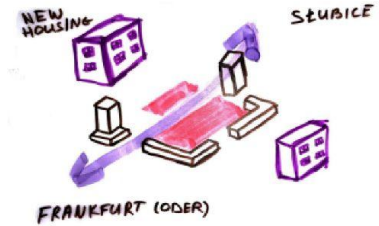
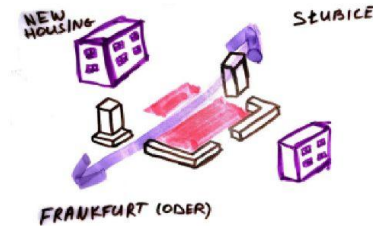
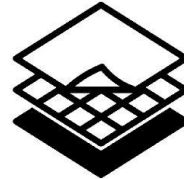
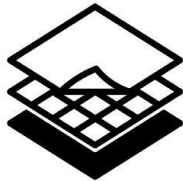

Lab's Participants and Working Groups



1. Functional analysis

Julia Szimak
Maisey Zheng
Qustandi Altork
Ola Gila

2. Social functions

Iryna Zaulychna
Anfisa Kaida

3. Mobility

Melisa Bahar Yildiran
Alina Sotieva
Oleksandr Pechankin

4. Greenery

Nana Shamatava
Shiori Hagiwara
Aynur Abbassoy
Siranush Grigoryan

Contents and program for Presentations' Day 01.09.2023

I. Spatial Analysis

1. Functional analysis
2. Mobility
3. Greenery

II. Concepts & Visions

1. Greenery
2. Mobility
3. Functions

III. City Walk

Surprise :)

Socially engaged art lab



1. Spatial Analysis

1.1 Functional analysis | Social uses

1.2 Mobility

1.3 Greenery

1.1. Functional Analysis | Land Use Map - Around Zukunftsplatz

- Mostly mixed use and residential
- Connection to city centre
- **Many places with no function - empty space**

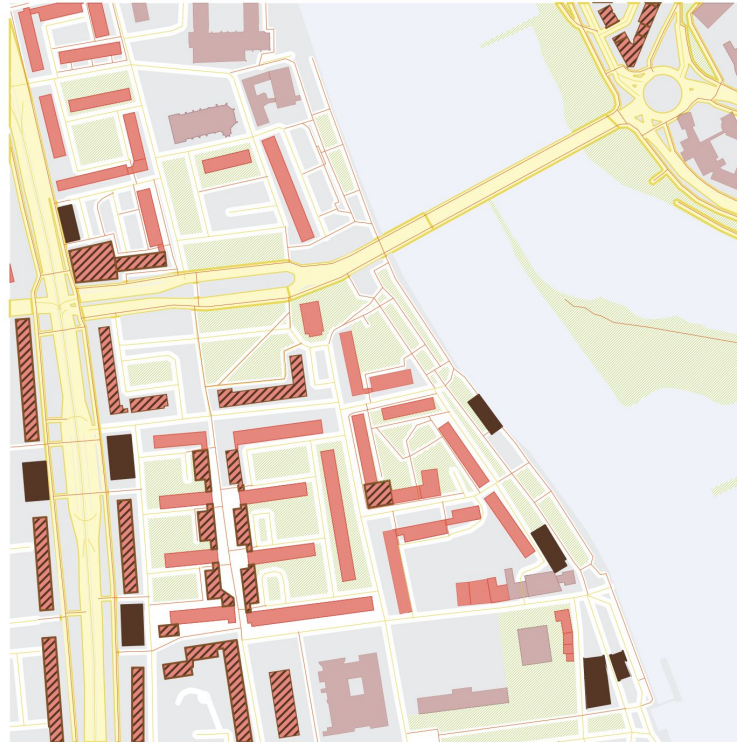

0 10 50 100

Legend

- housing
- commercial
- mixed use
- green area
- public service
- road
- water
- pedestrian path

1.1. Functional Analysis | Current Usage of the ZP

- A place of social innovation and urban intervention (past initiatives include: Helping Hands, founding of Słubfurt, Viadrinicum Summer School, Kollektiv Plus X)
- Gathering space for community building and organisation
- However, spatially filled with an emptiness and lack of purpose - structures all temporary, greenery unmanaged, building



1.1.Functional Analysis | Rethinking the Centre

- Lack of agreement between stakeholders/historically over centre of the city
- Analysing the radial structure of the city shows the centre pointing towards middle of bridge between Frankfurt and Słubice and along smaller roads beyond the main road

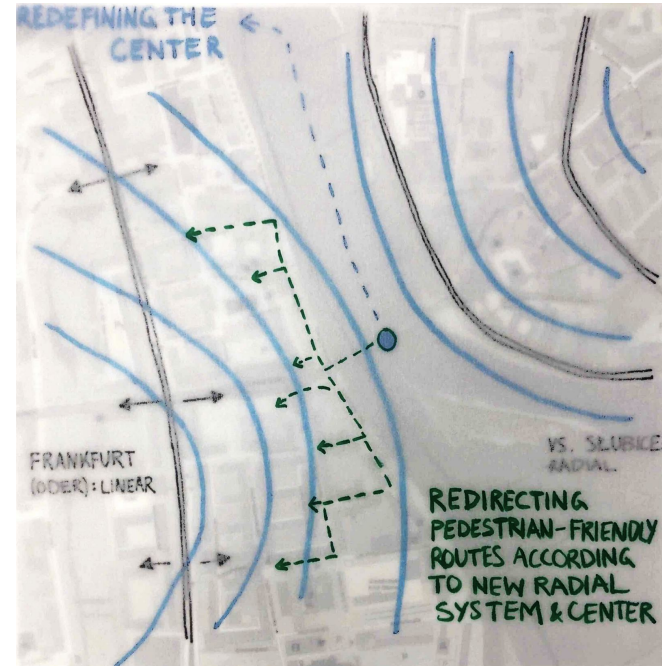
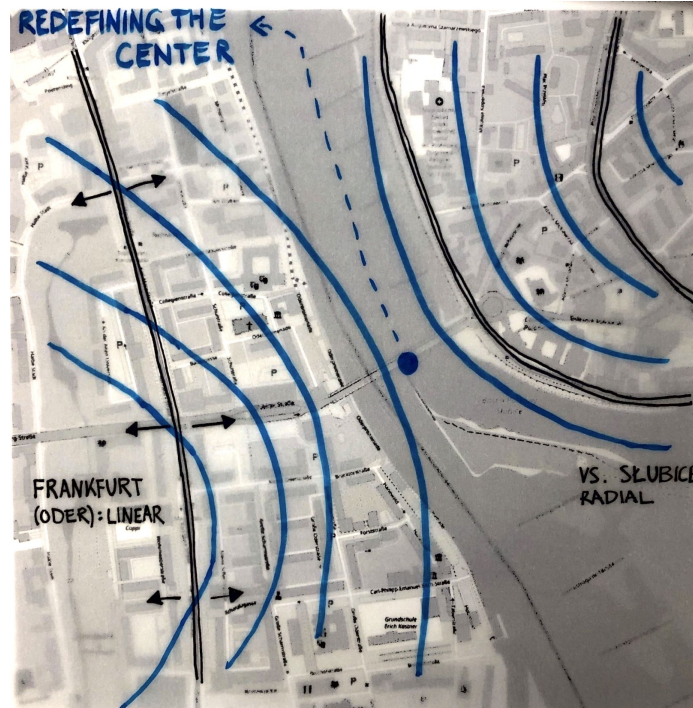

1.1.Functional Analysis | Points of Interest

Participatory mapping study* shows ‘meaningful places’ for local residents are close to the riverfront and the bridge

Through combining this local perspective with our own walking experience, we have highlighted points of interest including:

1. Port (only place in Frankfurt with direct access to water)
2. Under bridge (art festival and community activities)
3. Seated area behind abandoned church

Participatory Mapping Data

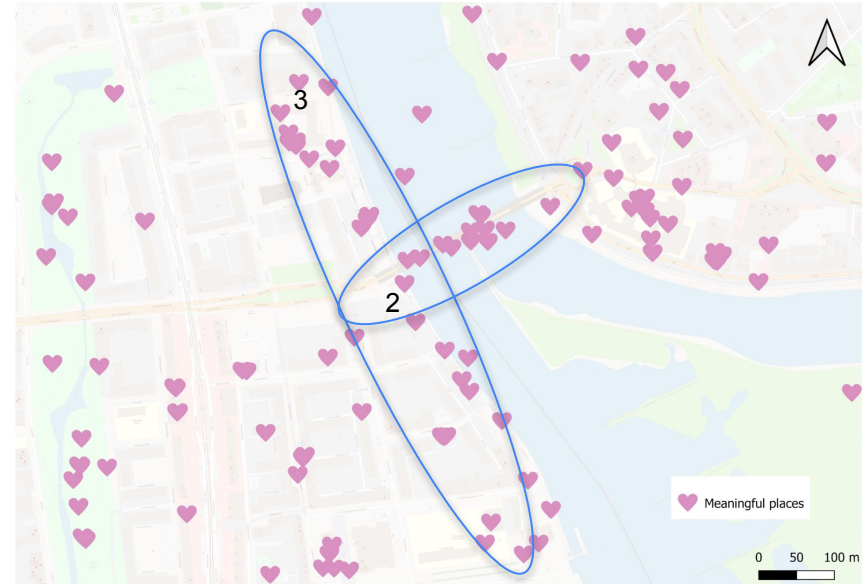

*Source: Sarah Gottwald & Iga Kołodzyńska (2023)

1.1. Functional Analysis | Walking through the city

Walking through the city and learning through the body - 'friendliness map' highlights pedestrian friendly zones

Lack of accessibility to riverfront (steep staircase - not suitable for wheelchairs, elderly, pushchairs) → a need to draw more attention to these areas beyond the bridge/main road

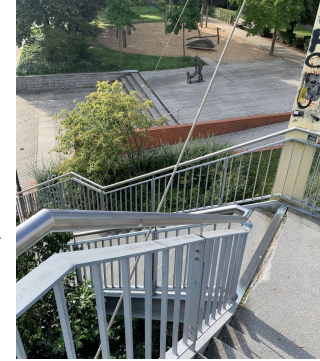

1.1. Functional Analysis | Social functions

Legend

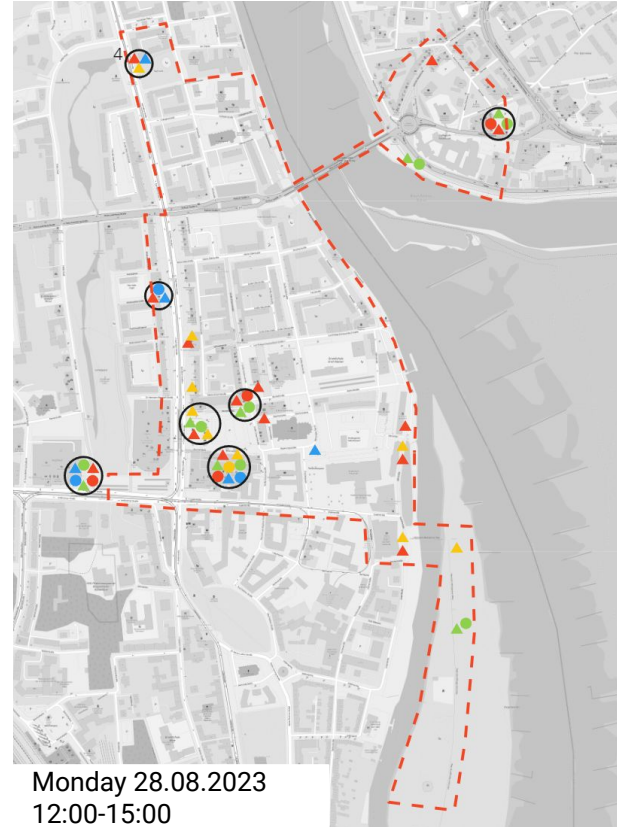
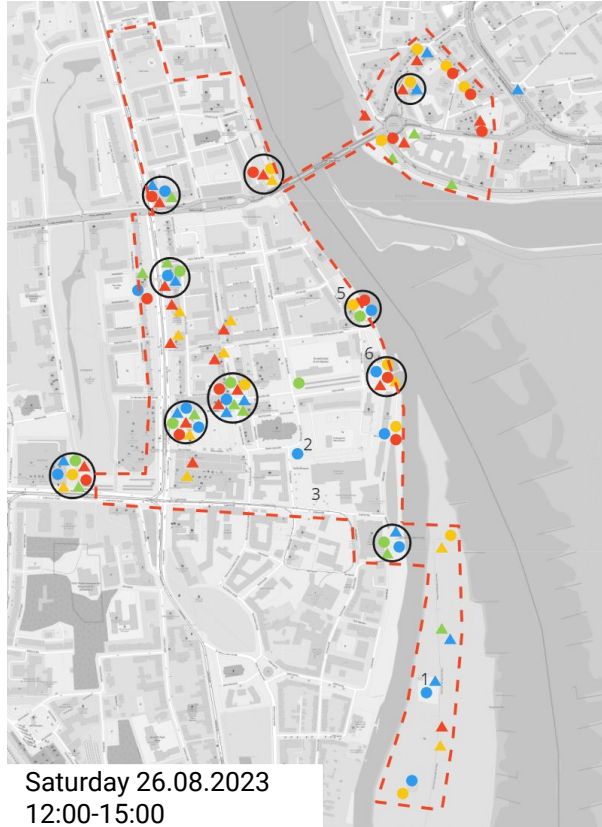

- ▲ local
- non-local
- parents&kids
- adults
- elderly
- young
- research area



- density and number of places used is lower on a weekday than on a weekend
- prefer public spaces with the functions of commerce and food
- users are inclined towards the main city roads
- lack of space usage
- only two of playgrounds are popular [1, 2]
- not many special public spaces for students [3]

1.1. Functional Analysis | Social Functions | Empty spaces

Legend

-  underused areas
-  potential areas
-  pedestrian ways

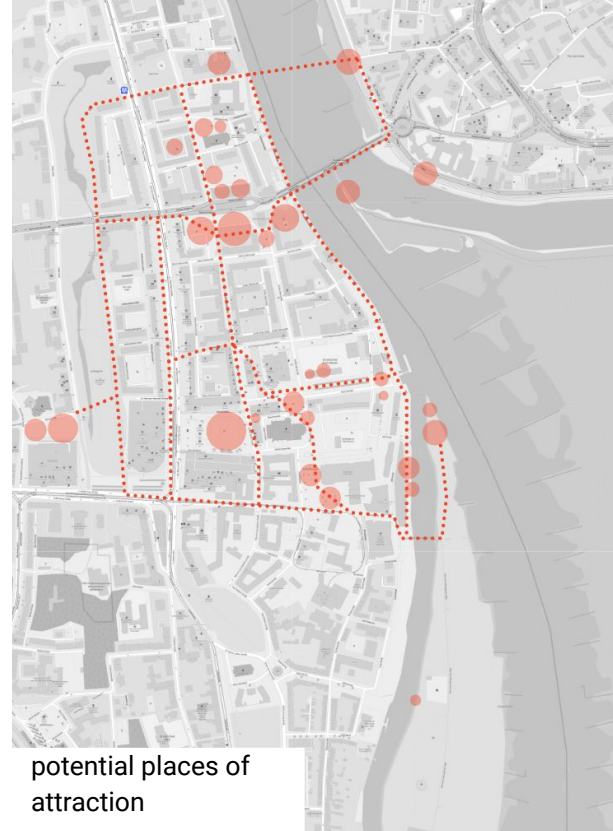
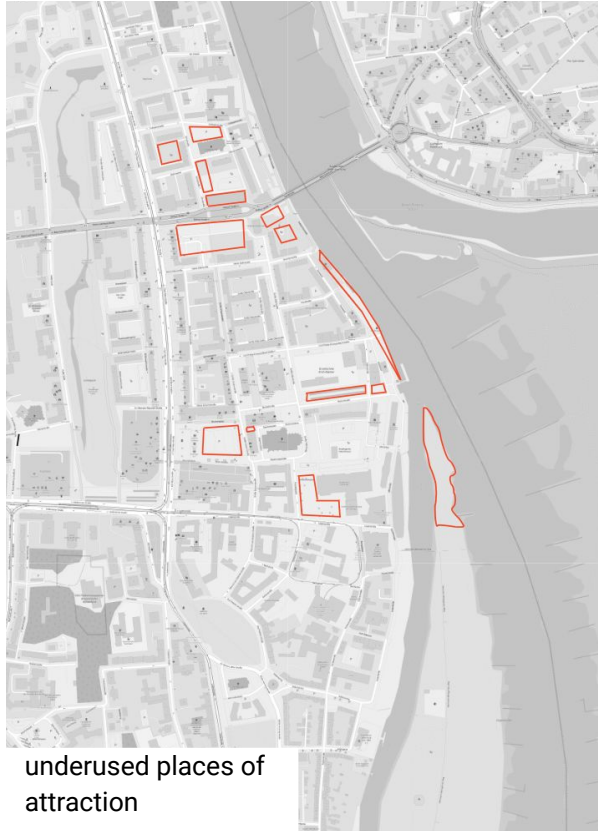

- Based on the previous maps, we identified two groups of public spaces: those designed to attract users and those with the potential to become public spaces. The red dotted line indicates potential local paths.
-

1.2. Mobility | General transport scheme

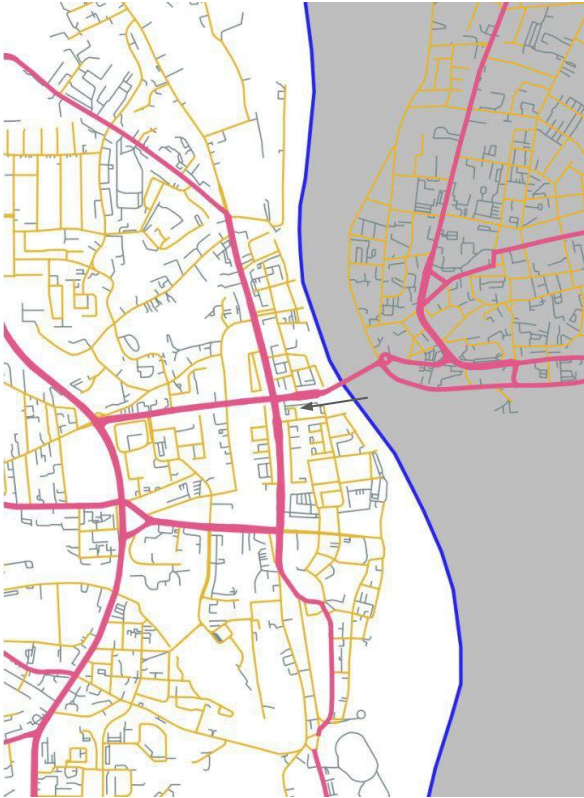

- raster structure on German side
radial structure on Polish side
- only 1 bridge connection
- Slubice is using Frankfurt`s public transportation
- inefficient land use in Zukunftsplatz
- high potential inner city area

- Main roads
- Secondary roads
- Service roads
- German - Polish border

1.2. Mobility | Slubicestraße | Deficiencies

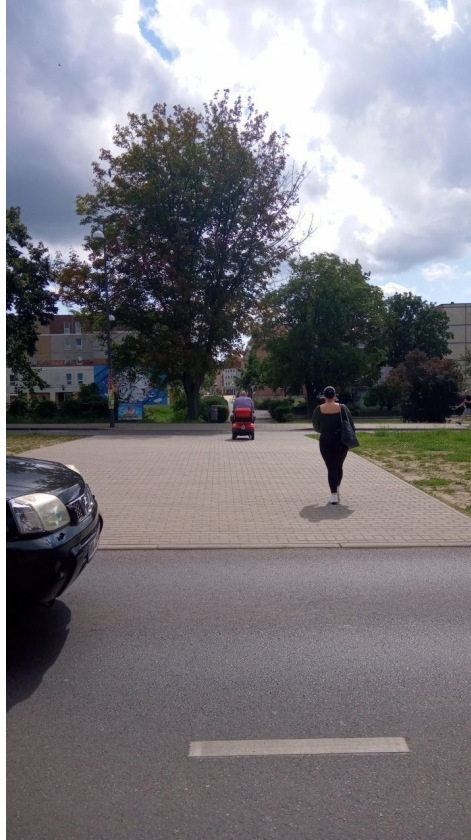

- too narrow pedestrian spaces — pedestrians are not prioritized
- border control has no space, which confuses all road users
- the road is too wide and is suitable only for cars
- no continuation of bicycle lane
- lack of zebra crossings, chaotic crossing by
- green island “eats up the space” and serves no function
- the road is under “District Road” category in German Urban Planning (hard to change its design)

1.3. Greenery | Green infrastructure Inner city



Legend

- Not dense green area
- Zukunftsplatz
- Underused green areas
- Parking lots
- Dense green area
- Abandoned green area

1.3. Greenery | Existing greenery around Zukunftsplatz



Legend



*The trees are counted and represented 1 to 1.

1.3.Greenery | Key observations

- **Residential Enclaves and Privacy Concerns – green areas are not accessible to general public**

The majority of existing green spaces are encircled by residential areas, limiting their potential as fully public green spaces. Residents' privacy concerns have resulted in a sense of exclusivity, making some green areas less welcoming for outsiders. Yet, the presence of playgrounds for residents underscores the importance of multifunctional green spaces that cater to diverse community needs.

- **The need for publicly accessible multifunctional green spaces**

There is a clear need for green spaces that will strike a balance between residents privacy and the accessibility of public amenities.

- **Deficiency of sidewalk green areas**

Certain areas exhibit lack of trees and bushes along sidewalks, which can have a negative impact on accessibility on overall aesthetics and walkability of the community.

The absence of greenery along sidewalks may contribute to urban heat island effects and limit the natural beauty of the neighbourhood.

- **Lack of connectivity between green areas of the city**

Green spaces of the city are disconnected, connection is hindered by several factors, including, lack of green infrastructure, especially on the highway openings.

Critical connection points lack pedestrian-friendly infrastructure such as crosswalks or zebra crossings, making it difficult for residents to move seamlessly between green spaces.

1.3. Blue Spaces | Key observations

Shortage of water reservoirs

The major water reservoir of the city is heavily polluted, in 2022 according to EU estimates, river was exposed to the largest ecological disasters in Europe.

The inner city water reservoirs such as small water channels and fountains are either dysfunctional or not serving usual functions of blue spaces.

Blue spaces are mostly disconnected from the green infrastructure of F(0).



2.

Spatial concepts & visions

2.1 Greenery

2.2 Mobility

2.3 Functions and uses

2.1. Greenery | Concepts for the inner city area

The Green Connectors with community open green space

Green urban planning that prioritizes accessibility, well-being, innovation, and sustainability. The city is seamlessly integrated with its larger hinterlands, with community open spaces acting as vital connectors between the main urban centers.

- **Green Corridors**

The city's urban planning has carved out green corridors that wind through the city, connecting neighborhoods, parks, and public spaces. These corridors are not just pathways but vibrant ecosystems filled with trees, native plants, and wildlife-friendly habitats.

- **Multi-Functional Green Spaces**

Community open spaces are designed with multi-functionality in mind. They serve as hubs for social interaction, recreation, and learning. They are suitable for cultural festivals, and outdoor performances, while also providing relaxation areas with seating and public art installations.

- **Bridging Cities and Beyond**

The plan recognizes the concept of dual-city. It aims connecting not only its own urban regions but also extending a hand across the border to the other side of the city.

2.1. Greenery | Design principles, roles of the green areas

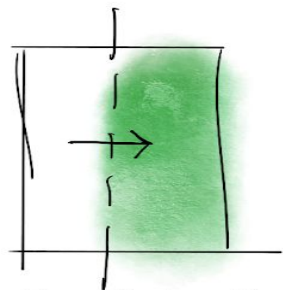

Transforming the space

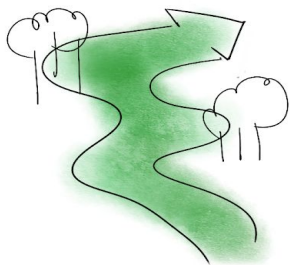

Learning journey through the space

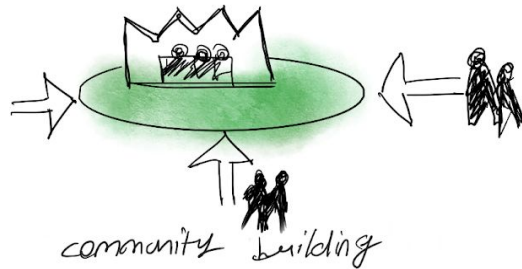

community building

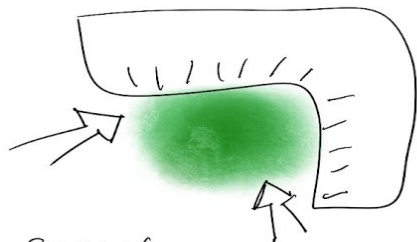

Sense of community with forms



visibility & Sense of Space

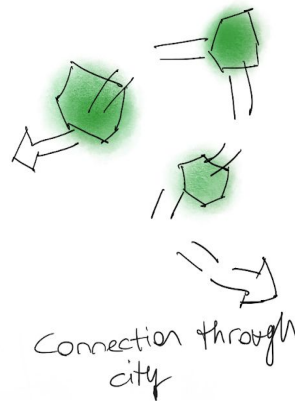

Connection through city

2.1. Greenery | Green connectors with open green space



2.1. Greenery | Examples of green connectors



Movable plant pots



Urban Gardening

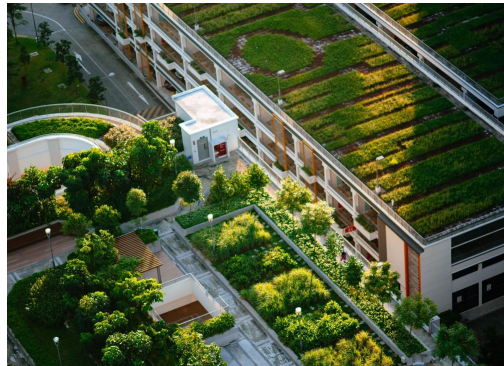

Green roofs



Blue spaces/fountains



Green Parking Slots



Colorful trees

2.1. Greenery | Vision for Zukunftsplatz

Zukunftsplatz – Green Nexus of Knowledge and Connection

Located at the heart of the dual-city of Frankfurt (Oder)-Slubice, ZP stands as the "Green Nexus of Knowledge and Connection," embodying the dual-city's spirit of unity, education, and sustainability.

ZP's unique location, nestled between two main city centers (according to the greenery map) and just near the border of the dual city, underscores its importance as a community open green space with multifaceted functionality.

This multifunctional community open green space is not only a bridge between city centers but also a source of inspiration for residents and visitors alike, fostering a sense of belonging and shared responsibility for the well-being of the entire region.

2.1. Greenery | Concept for ZP | Green corridor in F(O)

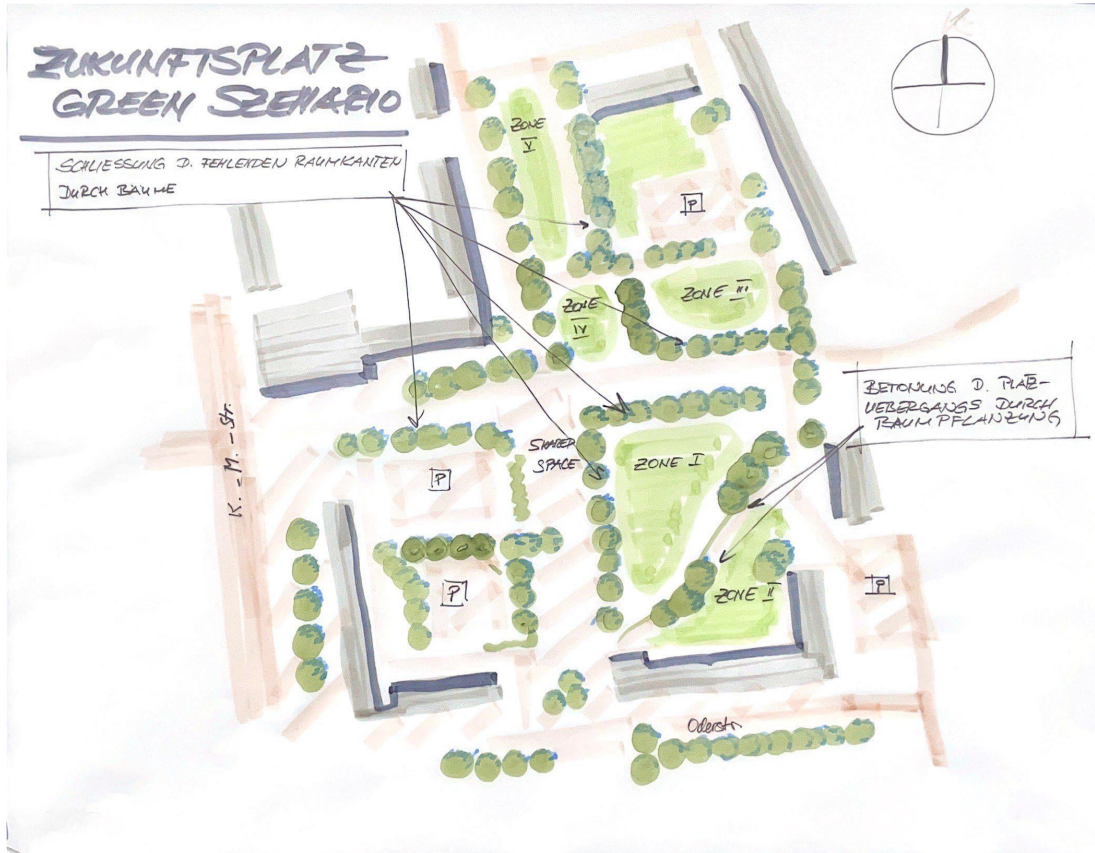

Medium term perspective, minimally invasive and costly intervention, that creates green corridor and shade at the Zukunftsplatz, supporting the existing functions.

2.2. Mobility concepts | Slubicestraße – Shared space



- expanding the space for pedestrian safety through minimising the motor vehicle lanes
- separated bike lane to reduce road crashes and fatalities
- slowing down the traffic to increase walkability with pedestrian cross and speed bump
- green barrier for separation and noise cancelling

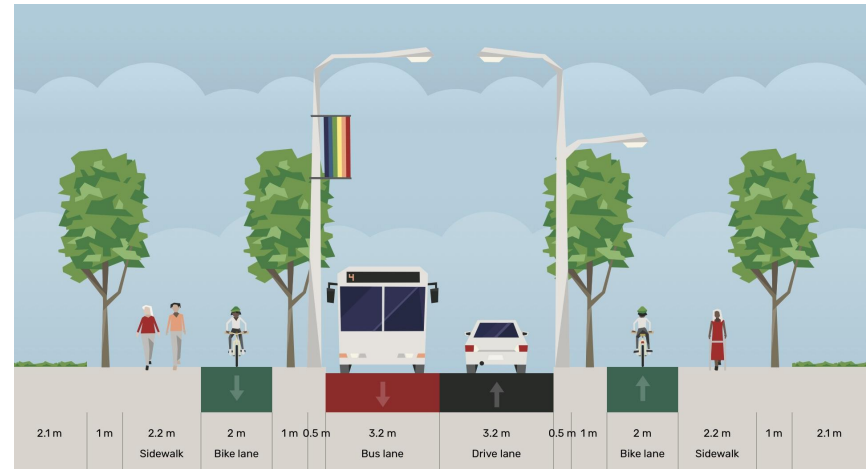

Road section of Slubicestraße. Own representation.

2.2. Scenario 1 | Mobility concepts | Densification scenario

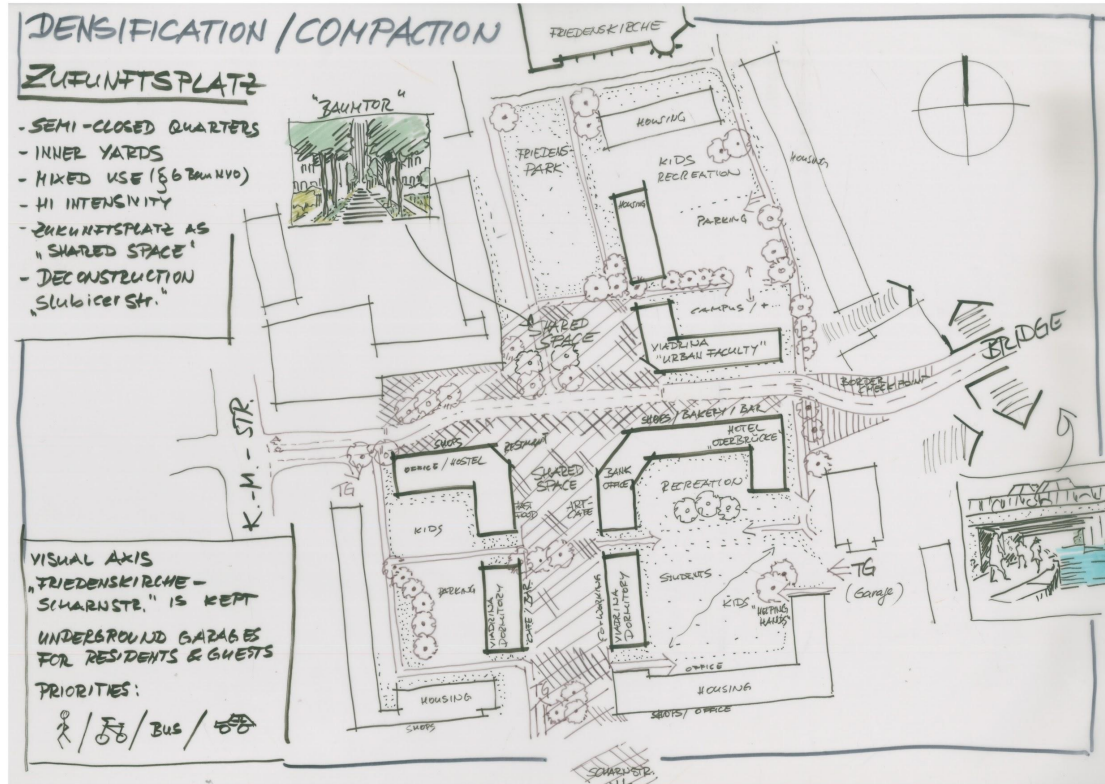

2.2. Scenario 1 | Mobility concepts | Movements and uses

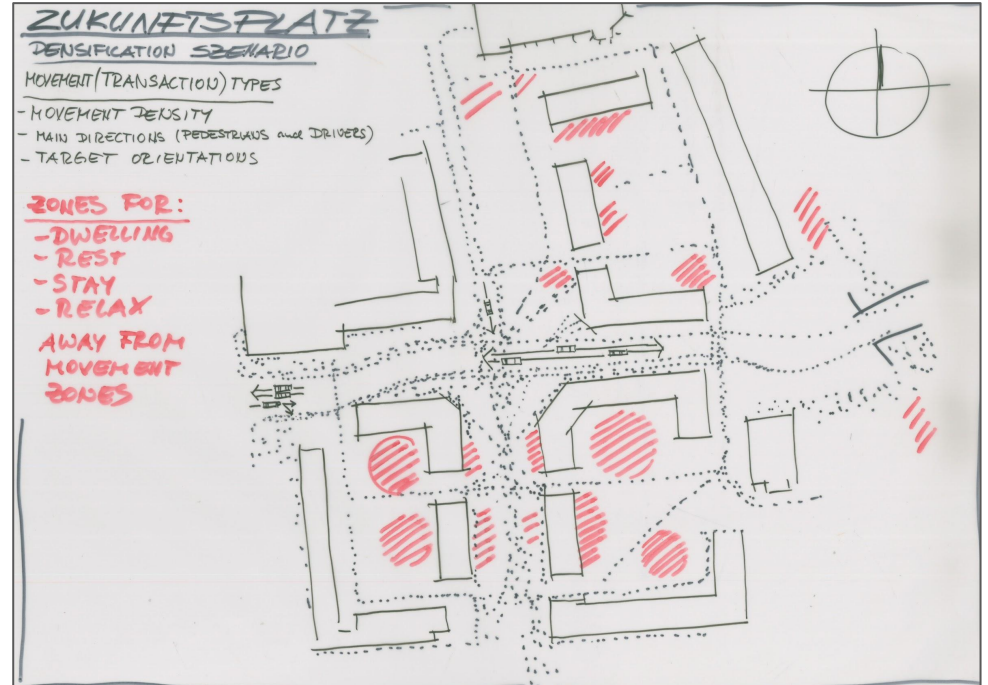
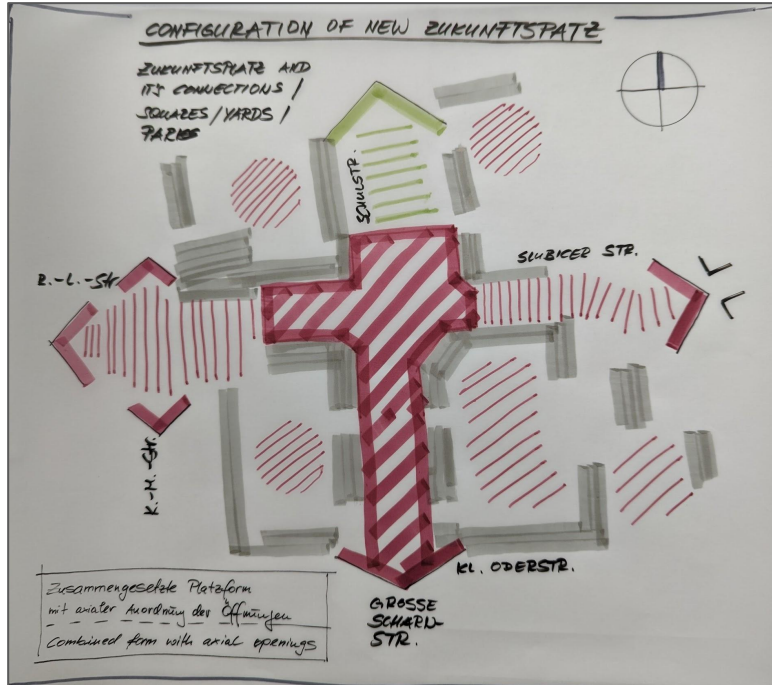

2.2. Scenario 2 | Mobility concepts | Mixed use development

ZUKUNFTSPLATZ - AMPHITHEATRE SCENARIO

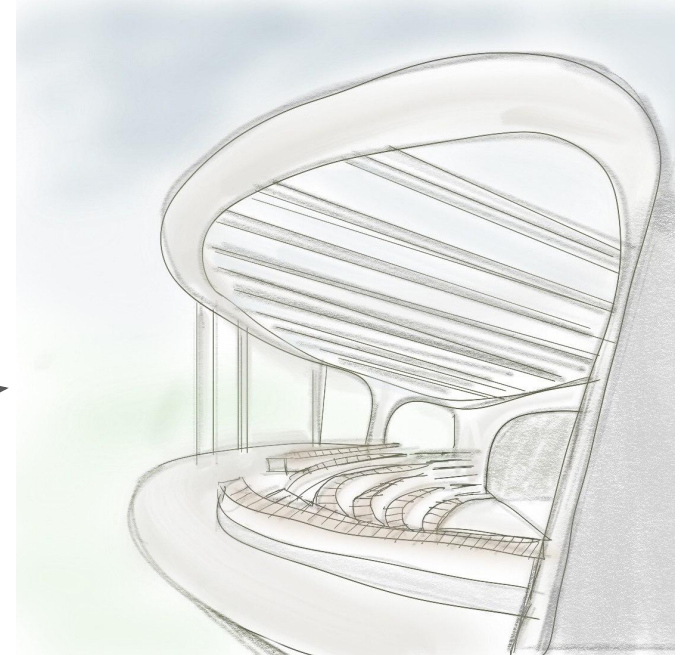

2.2. Scenario 2 | Mobility concepts | Amphitheatre

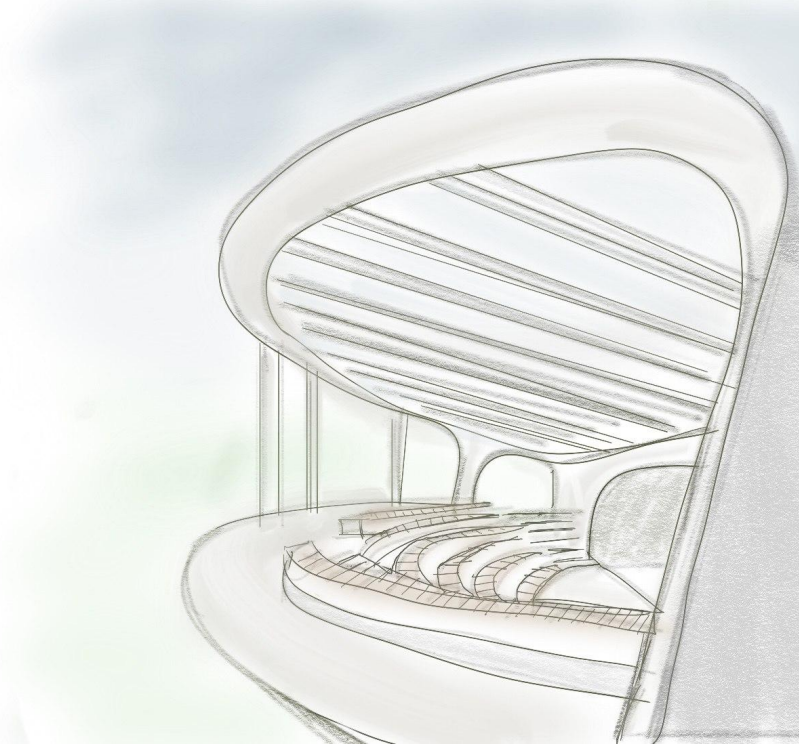

Function

- inviting and attractive space to form new and support existing communities
- educational hub
- place for cultural engagements

Form

- outdoor scene as a public open space with multipurpose use
- semi-circle shape encourages people to gather
- transparent roof with green zones for weather protection
- greenery surrounding to create a sense of nature in the city center

2.2. Scenario 2 | Mobility concepts | Mixed use development

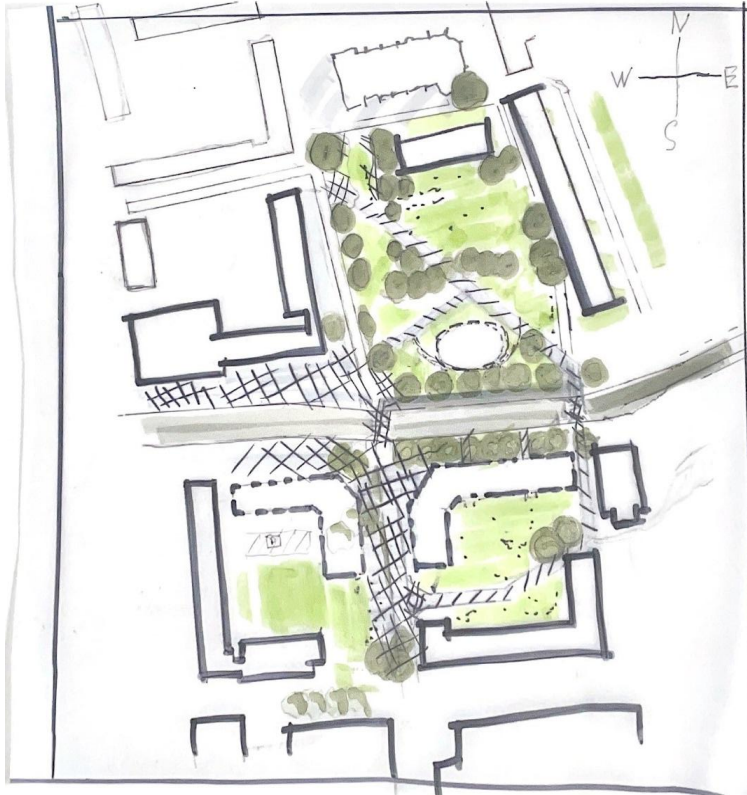

Version 2 with amphitheatre on the northern part of the square

Space allows to create different possible sets and combinations of functions of the quarters of the square.

2.3 Pedestrian bridge* | Improving connectivity and walkability

Proposed bridge with meaningful places

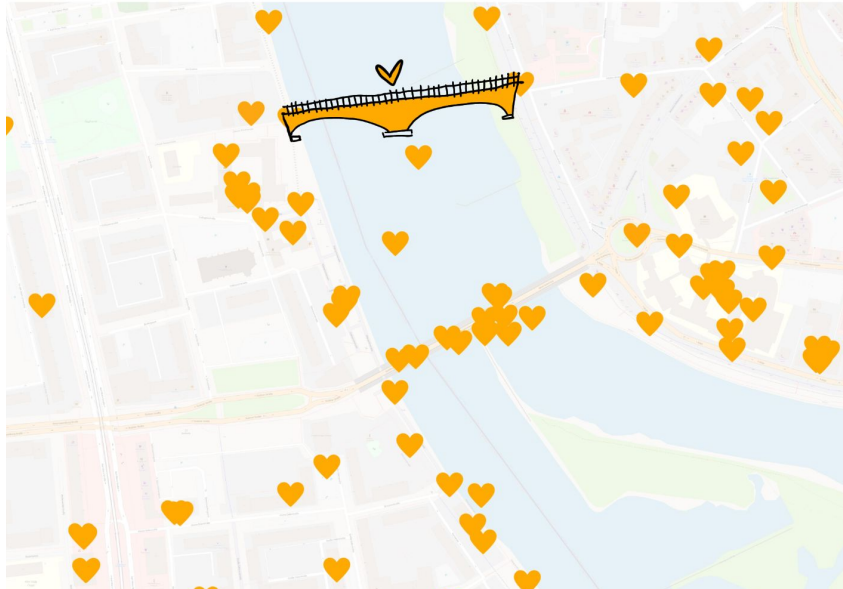

Proposed bridge with meaningful places hotspots

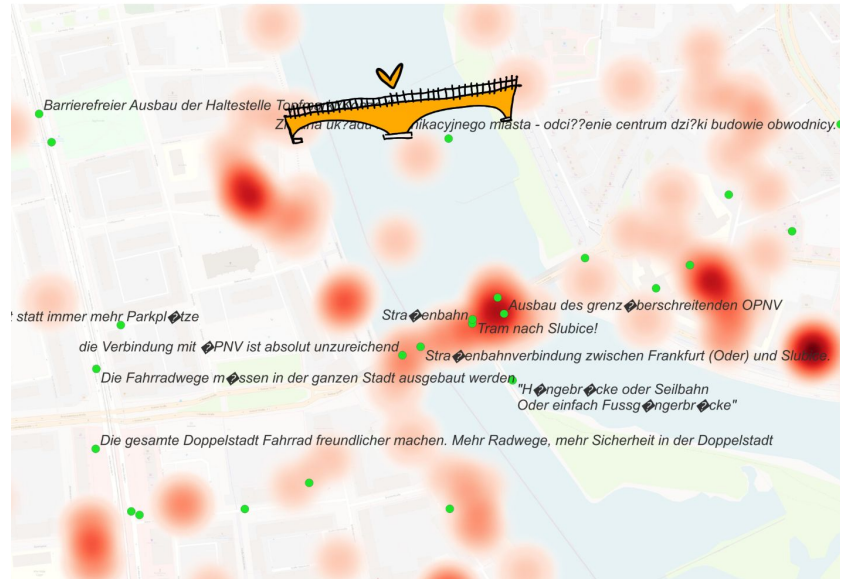

Own representation based on: Sarah Gottwald & Iga Kołodzyńska (2023)

During the search process, roads in both cities that crossed the river in a straight line were found to be located in a under-used part of the city, which is also objectively considered to be the centre.

*Social functions group

2.3 Pedestrian bridge | Improving connectivity and walkability

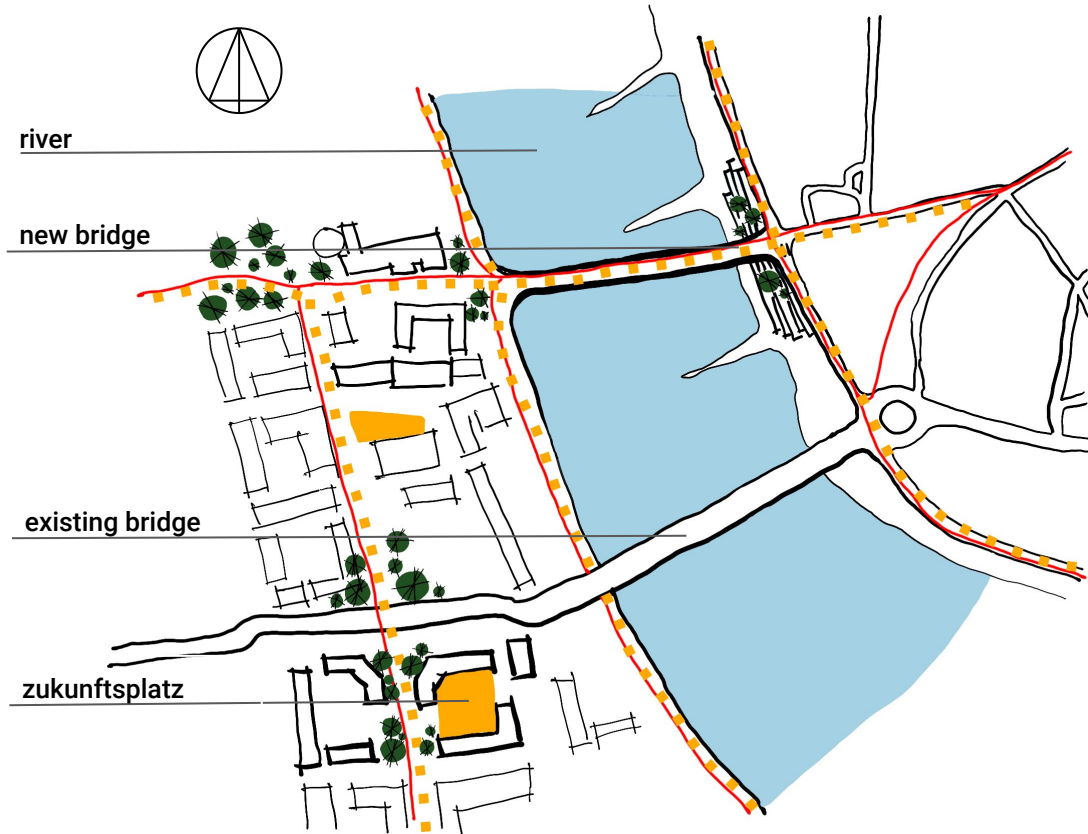

Therefore, in order to increase activity in this area of the city and provide better access to public spaces such as the concert hall, bars, library and city parks for the residents of Slubice, a pedestrian bridge is proposed. With this solution, we expand the city center.

2.3 Pedestrian bridge | Improving connectivity and walkability

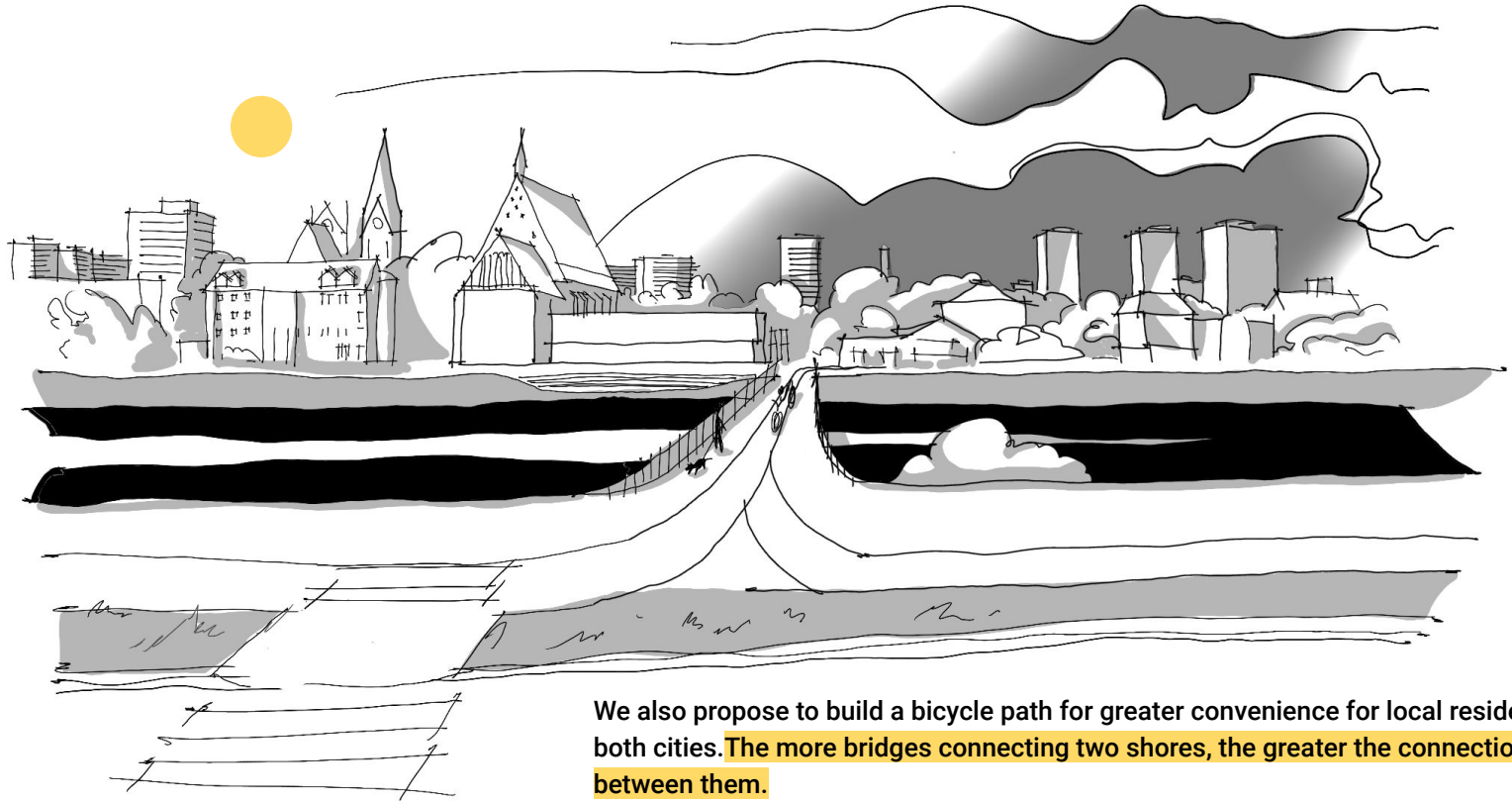

We also propose to build a bicycle path for greater convenience for local residents of both cities. **The more bridges connecting two shores, the greater the connection between them.**

2.3 Multifunctional park | Rethinking of current space

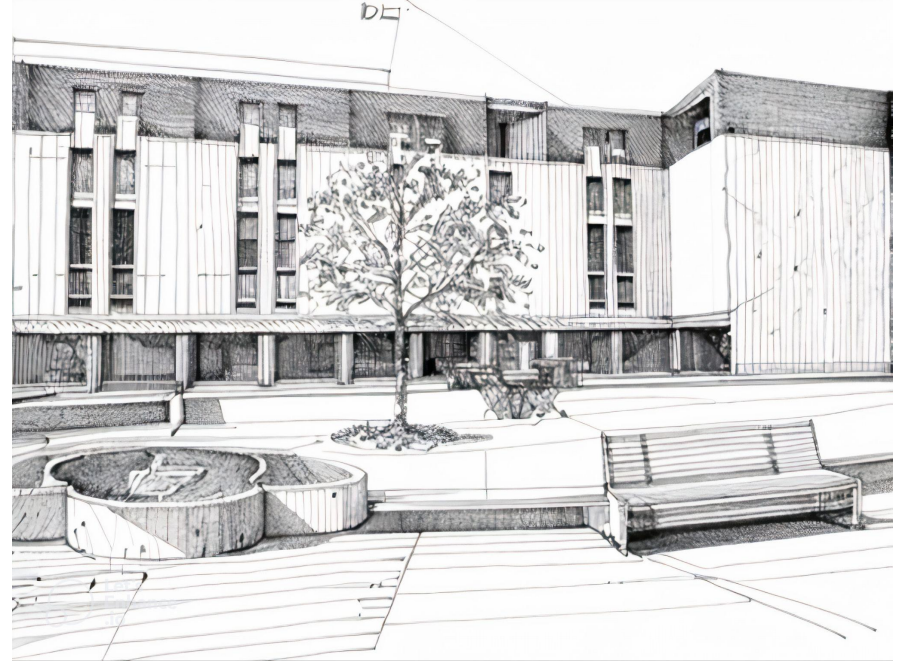

As the pedestrian bridge expands the area of the existing city center, Zukunftsplatz is relocated to the heart of Frankfurt. It will be at the crossroads of pedestrian paths.

2.3 Multifunctional park | Rethinking of the current space

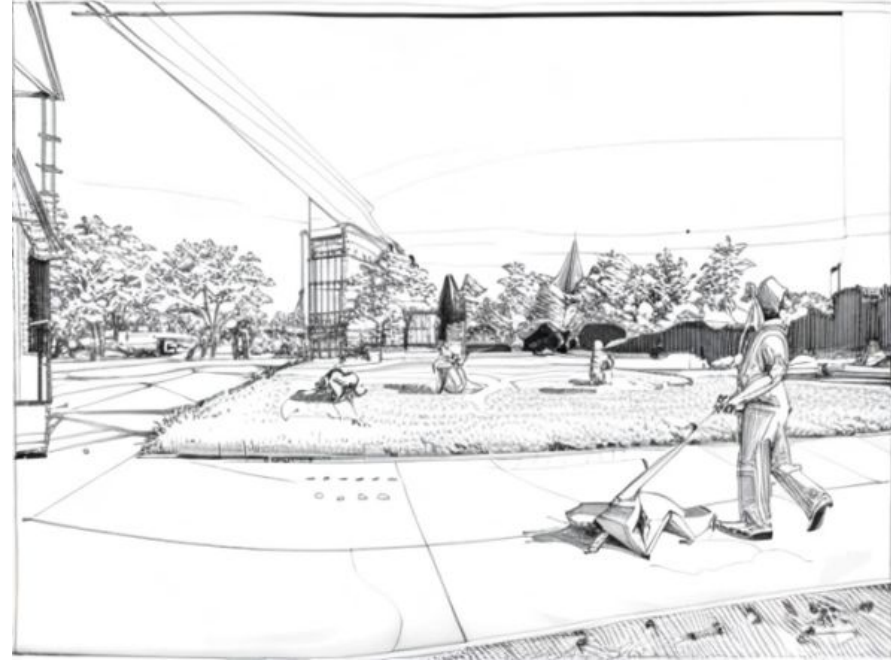

The total area (0.5 ha) allows to divide Zukunftsplatz into **two separate zones**: a **commercial** ground floor and a **green recreation area** with outdoor picnic furniture. In between is a **path for dog owners** to walk their pets. This division allows us to take into account the **interests of key stakeholders**.

2.3 Maintain Existing Functions | Zukunftsplatz social innovation

Zukunftsplatz – Protect its existing ‘function’ as a space for social innovation

1. Important space for urban enthusiasts and wider community: access to knowledge, a meeting point, a place for activism

[Suggestions: plant more trees, benches, path - make it a more pleasant and permanent space for people to meet]

2. Starting point to learn more about the city (see walking tour: exploring the city)



Source: AI-generated image

2.3 New Function Mapping | Moving beyond traditional functions

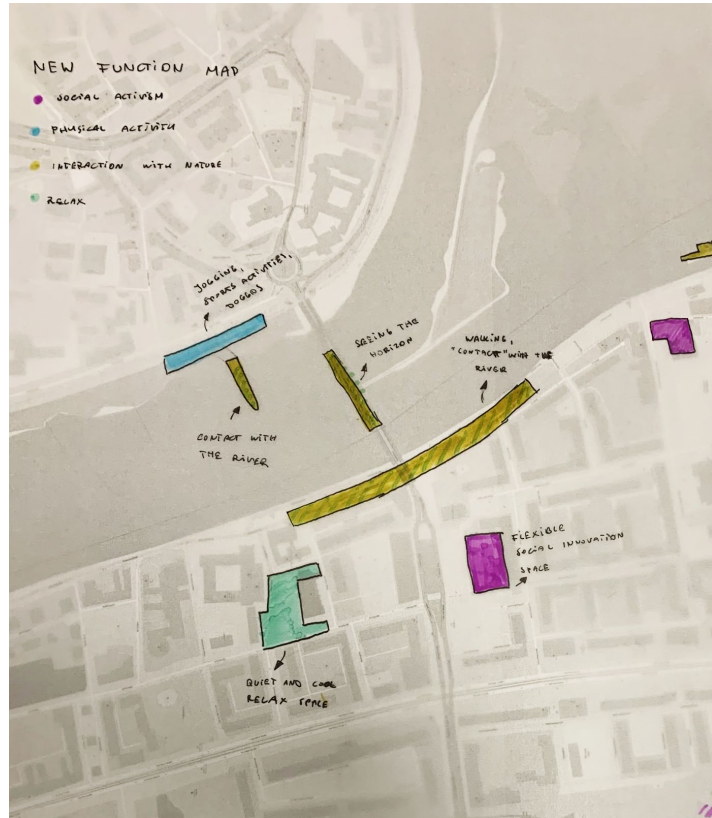

Legend

-  Social activism
-  Physical activity
-  Interaction with nature
-  Relax



Redefining functions with non-traditional categories in order to preserve their meaning

Focus on social interaction and human-centred experience

3. Walking Tour | Learning through walking

FutureWalk: short-term intervention that reroutes the city from the main road, explores 'hidden' parts of the city obscured by the view from the bridge and main road

This tour is:

- Pedestrian friendly (sensitive to different sounds)
- Close to the river (of which there is limited access)
- Inclusive: mobility-friendly
- Interactive: invites people to imagine what they want to see in these empty spaces with QR codes to post suggestions



future walk

ścieżka przyszłości • Zukunftsweg

EN

Future Walk is an initiative created by the Viadrinum summer school 2023, exploring the concept of learning in cities. Here, we invite people of Frankfurt (Oder) and Slubice to reflect and question the possibilities for the spaces we inhabit. Scan the QR Code to share your ideas see how other people in Frankfurt and Slubice imagine this space.

PL

Future Walk (Ścieżka przyszłości) to inicjatywa stworzona przez szkołę letnią Viadrinum 2023, w trakcie której eksplorujemy koncept uczenia się w mieście. W tym projekcie zapraszamy mieszkańców Frankfurtu nad Odrą oraz Słubic do refleksji na temat przestrzeni miejsc w której się znajdujemy. Zachęcamy do zeskanowania kodu QR aby podzielić się opinią oraz zobaczyć jak inni mieszkańcy wyobrażają sobie tę przestrzeń.

DE

Future Walk (Zukunftsweg) ist eine Initiative, erstellt im Rahmen der Viadrinum Summer Schule 2023, die sich mit dem Konzept des Lernens in Städten beschäftigt. Wir laden die Bewohner von Frankfurt (Oder) und Slubice dazu ein, über die Möglichkeit der Räume, in denen wir leben, nachzudenken und sie zu hinterfragen. Scannen Sie den QR Code, um uns Ihre Ideen mitzuteilen, und zu erfahren, wie sich Ihre Mitmenschen aus der Region diesen Raum vorstellen.

Scan me!



future walk

ścieżka przyszłości • Zukunftsweg

You can **sit** under a big tree, **talk** to friends, **share** your ideas and **engage** with your community.

Sie können unter einem großen Baum **sitzen**, ihre Ideen mit Freunden **teilen** und sich an Ihrer Gemeinschaft aktiv **beteiligen**.

Możesz **usiąść** pod dużym drzewem, **porozmawiać** z przyjaciółmi, **podzielić się** pomysłami i **zaangażować** w lokalną społeczność.

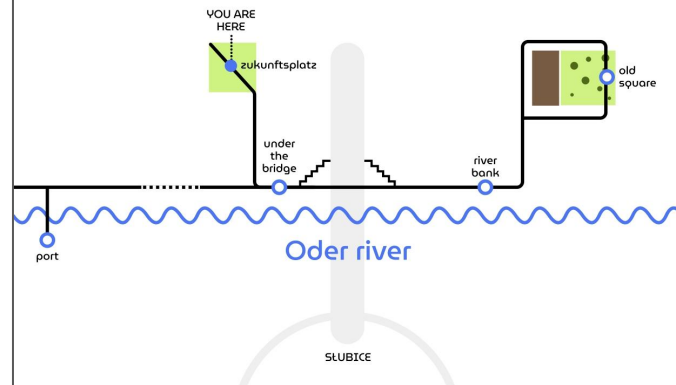

future walk

ścieżka przyszłości • Zukunftsweg

You can **enjoy** a coffee on a bench, **look** at the river and **find** shade on a hot day.

Sie können auf einer Bank **sitzen** und Ihren Kaffee **genießen**, auf den Fluss hinaus **schauen** und einen schattigen Platz an einem heißen Tag **finden**.

Możesz **cieszyć się** picciem kawy na ławce, **obserwować** rzekę i **znaleźć** cień w upalny dzień.

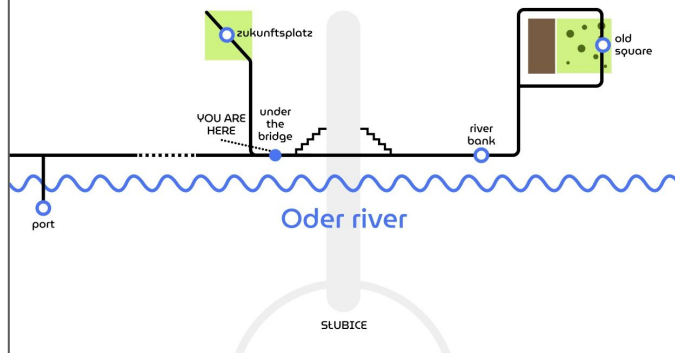

future walk

ścieżka przyszłości • Zukunftsweg

You can **listen** to live music, **get to know** new people and go for a bike ride by the river.

Sie können Live-Musik **hören**, neue Leute **treffen** oder einen Radausflug am Fluss machen.

Możesz **posłuchać** muzyki na żywo, **poznać** nowych ludzi i **wybrać się** na przejażdżkę rowerową.

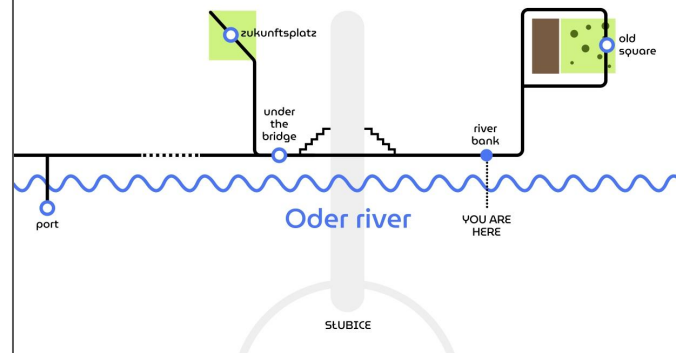

future walk

ścieżka przyszłości • Zukunftsweg

You have space to **sit** by the river, **listen** to the sounds of water and **enjoy** a drink with friends.

Sie finden einen Platz, um am Fluss zu **sitzen**, den Geräuschen des Wassers zu **lauschen** und ein Getränk mit Freunden zu **genießen**.

Masz przestrzeń, aby **usiąść** nad rzeką, **posłuchać** dźwięków wody i **cieszyć się** popołudniem z przyjaciółmi.

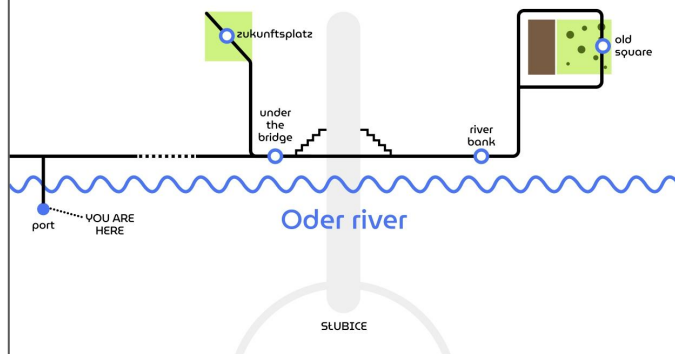

future walk

ścieżka przyszłości • Zukunftsweg

You can **enjoy** the calm underneath the old trees, **listen** to the harmony of the instruments and **retreat** from the city hustle.

Sie können die Ruhe zwischen den alten Bäumen **genießen**, der Harmonie der Instrumente **lauschen** und sich von dem Gewirr der Stadt **zurückziehen**.

Możesz **cieszyć się** spokojem starych drzew, **posłuchać** dźwięków instrumentów i **odpocząć** od miejskiego zgiełku.

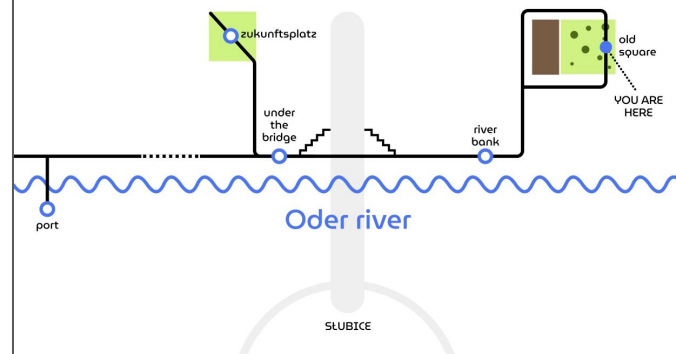

3. Walking Tour | Learning through walking



On the tour to the underused spaces and their potential new uses.



Thank you!!!

Now let's walk and learn
together